

## Electric Motor Driven



# Internal Gear Type Positive Displacement Pumps



## 1.5 Horsepower

**DESCRIPTION**

Internal gear pumps are high quality units capable of 15 ft. (5 m.) of lift and smooth, consistent flow. Models feature a type 21 seal for pressures up to 200 psi (13,8 Bar). With flow up to 12 gpm (0.8 lps) and a maximum viscosity of 1500 SSU, these units are available with either a 1–1/2 H.P. totally enclosed fan cooled (TEFC) or explosion-proof motor.

These cast iron gear pumps are reliable, cost-effective and low maintenance.

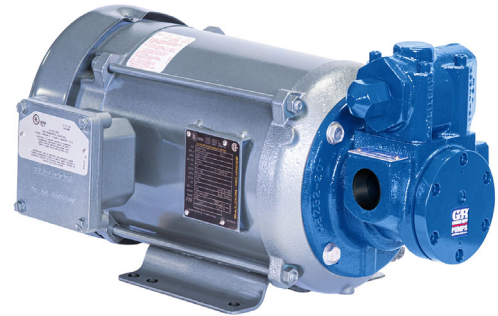

GMC1DE3–X1.5 1P SHOWN

**PUMP SPECIFICATIONS**

**Basic Construction:** Gray Iron.

**Rotor and Idler:** High Strength Iron.

**Bushings:** Carbon Graphite.

**Idler Pin:** Hardened Steel.

**Seal:** Type 21, Mechanical Self Lubricated. Carbon Rotating Face. Ceramic Stationary Face. Fluorocarbon Elastomers (DuPont Viton or Equivalent).

Maximum Temperature of Liquid Pumped 300°F (149°C).

**Gaskets:** Synthetic Fiber w/Nitrile Binder.

**O-Rings:** Fluorocarbon (DuPont Viton or Equivalent).

**Pressure Relief Valve:** Ductile Iron.

Pressure Setting: 75 PSI (5 BAR).

**Motor Speed:** 1750 RPM.

Rotation: Clockwise.

**SPECIFICATIONS**

Model	Ship Wt. (Approx.)	Suct. x Disch. (NPT)	Motor Type	VAC 60 Hz	H.P.	Amps
GMC1DE3–E1.5 1P	59 lbs. 26,8 kg.	1" x 1"	TEFC, Single Phase, Continuous Duty.	115/230	1.5	12.4/6.2
GMC1DE3–E1.5 3P	59 lbs. 26,8 kg.	1" x 1"	TEFC, Three Phase, Continuous Duty.	230/460	1.5	4.6/2.3
GMC1DE3–X1.5 1P	59 lbs. 26,8 kg.	1" x 1"	X-Proof, Single Phase, Continuous Duty.	115/230	1.5	19.0/9.5
GMC1DE3–X1.5 3P	59 lbs. 26,8 kg.	1" x 1"	X-Proof, Three Phase, Continuous Duty.	230/460	1.5	4.6/2.3



GORMAN-RUPP PUMPS

[www.grpumps.com](http://www.grpumps.com)

Specifications Subject to Change Without Notice

Printed in U.S.A.

**Specification Data**

SECTION 520, PAGE 25

**APPROXIMATE DIMENSIONS**

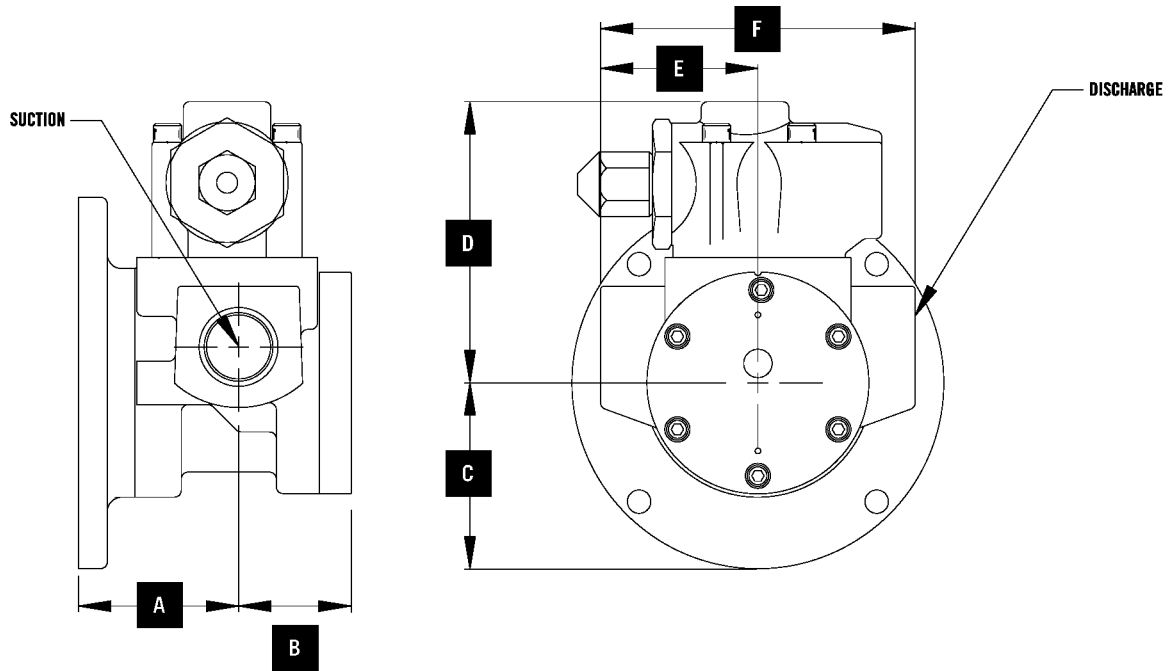

DIMENSIONS							
A	B	C	D	E	F	Suct.	Disch.
2.8 (71,1)	2.7 (68,6)	3.3 (83,8)	5.2 (132,1)	2.5 (63,5)	5.0 (127,0)	1" NPT	1" NPT

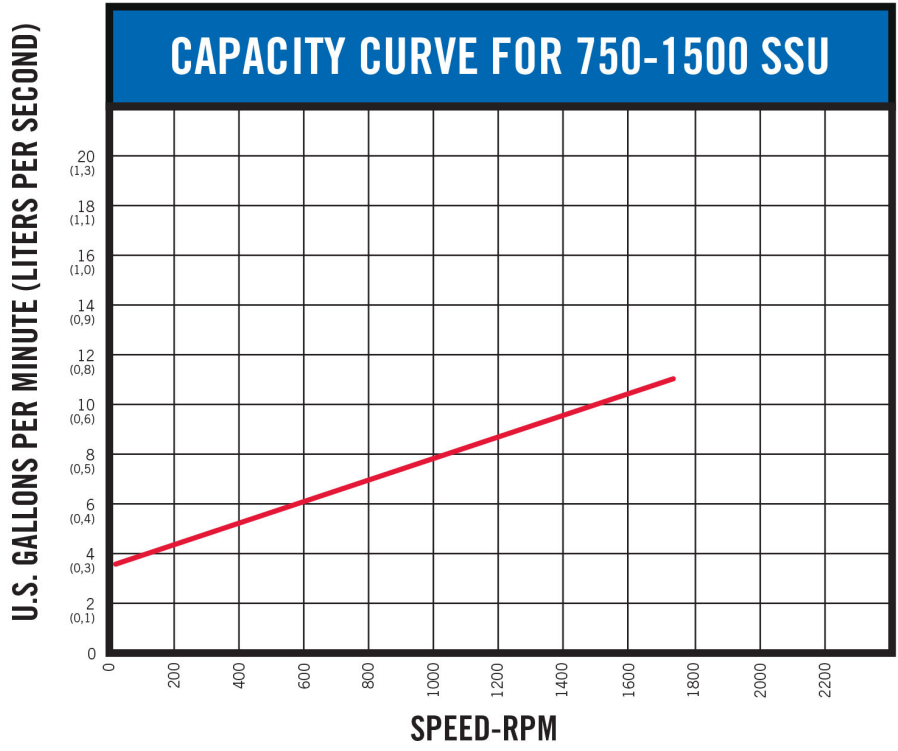

**GORMAN-RUPP PUMPS**

www.grpumps.com

Specifications Subject to Change Without Notice

Printed in U.S.A.